

# MACKINDER HALL



## Things you need to do before you arrive

1. Read your student residence agreement [here](#).
2. Complete your compulsory induction via the accommodation portal.
3. Book your arrival slot.
4. Read the *Halls A-Z handbook*.
5. Visit the [accommodation arrivals webpages](#).

## Need to get in touch?

accommodationonline@reading.ac.uk  
0118 200 5011  
+44 118 200 5011 (international)

.....  
View more images on our flickr [here](#)

Find local area information [here](#)

## KEY FACTS

# MACKINDER HALL

### Hall address

Your name, flat, block  
Mackinder Hall, Shinfield Road, Reading  
RG6 6HA (Ashbury)    RG6 6HE (Enbourne)  
RG6 6BE (Blewbury)    RG6 6HF (Fawley)  
RG6 6HS (Cholsey)    RG6 6HH (Hurley)

Mackinder Hall is part of Park Group.

### Reception

Reception is on the ground floor of Windsor Hall.

### Post

Postboxes are on the outside wall of Park Lounge.  
Collect parcels and registered mail from Park Reception  
between 08:30–09:30 and 14:00–18:30.

### Lift access

Yes. Rooms arranged over five floors.

### Social facilities

Park Lounge room contains a TV screen and pool table.  
Located opposite Park Eat. Allocated study space is  
Hurley Study Space.

### Special requirements

Single-sex areas and some accessible rooms are available  
in this hall.

### Meal Plan?

**The University recommends all first year students enrol onto a Meal Plan.** If you haven't already, you can enrol onto a fixed price Meal Plan, ranging from 3 to 21 meals per week, by visiting [www.clever-cuisine.com](http://www.clever-cuisine.com). The closest catering outlet is Park Eat.

### Your kitchen

Each Kitchen is equipped with a fridge/freezer, kettles, toasters, microwave, hobs and oven and is shared between five and eight residents. Each resident has one fridge and freezer shelf and two cupboards.

### Do I need induction pans?

**Yes.** Mackinder Hall has induction hobs. You need a particular type of pan called 'Induction pans'. We suggest stainless steel flat bottom pans. If purchasing a kitchen pack, please select 'induction hob kitchen pack'.

### Walking distance

5 minutes to central Whiteknights Campus.

### Nearest public transport

UoR Chancellor's Way: 5 minutes  
Bus: 21 or 21a

### Bed size

- Premium en-suite: 4'0"x6'3" (122cm x 190.5cm)

Each room contains bed, desk, chair, shelves, curtains, wardrobe and rubbish bin. There is also storage under the bed.

**En-suite bathrooms** have a toilet, sink, washbasin and shower with a curtain and an adjustable showerhead. Accessible rooms have a 'wet room' style bathroom. They also have a shaver/toothbrush socket.

### Example premium en-suite floorplan

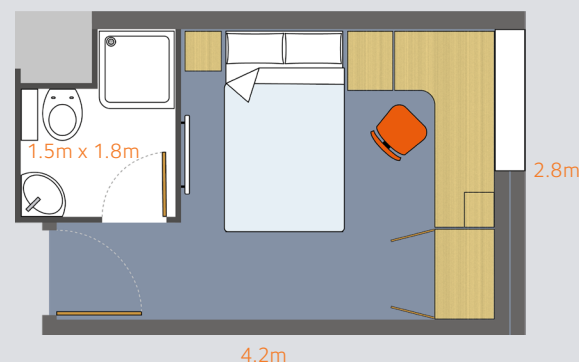

Not to scale. Room measurements are approximate only. This is not the guaranteed size of your room. Approximate room size = 11.8m<sup>2</sup>.

### Need to get in touch?

[accommodationonline@reading.ac.uk](mailto:accommodationonline@reading.ac.uk)

0118 200 5011

+44 118 200 5011 (international)

View more images on our flickr [here](#)

Find local area information [here](#)