



Things you need to do before you arrive

1. Read your student residence agreement [here](#).
2. Complete your compulsory induction via the accommodation portal.
3. Book your arrival slot.
4. Read the *Halls A-Z handbook*.
5. Visit **Welcome to the University of Reading**.

Need to get in touch?

accommodationonline@reading.ac.uk

0118 200 5011

+44 118 200 5011 (international)

View more images on our flickr [here](#)

KEY FACTS

WINDSOR HALL

Hall address

Your name, room number
Windsor Hall
Shinfield Road
Reading, RG6 6HW

Windsor Hall is part of Park Group.

Reception

Reception is on the ground floor of Windsor Hall.

Post

Postboxes are on the outside wall of Park Lounge.
Collect parcels and registered mail from Park Reception
between 08:30–09:30 and 14:00–18:30.

Lift access

Yes. Rooms arranged over six floors.

Social facilities

Park Lounge room contains a TV screen and pool table.
Located opposite Park Eat. Allocated study space is
Park Lounge.

Special requirements

Single-sex and Quieter lifestyle areas are not available
in this hall.

Meal Plan?

Windsor Hall is a Meal Plan Hall. Each floor has one or
two pantries shared by all residents on that floor. Pantries
have a fridge/freezer, a kettle, toaster and a microwave
but no hob and oven. As this is a Meal Plan hall, please be
mindful of limited storage space in pantries.

As part of the Platinum Meal plan, you get 21 Meal
Swipes per week during term time. You can check your
balance/plan by downloading the CBord GET app or going
to **get.cbord.com**, selecting University of Reading and
signing in using your University username/password.

Your Meal Plan operates differently during Vacation
periods. Visit **www.reading.ac.uk/clevercuisine** for
further details (see My Plan) and for all other information
about your Meal Plan.

Catering outlets

The closest catering outlet is Park Eat.

Walking distance

8 minutes to central Whiteknights Campus.

Nearest public transport

UoR Chancellor's Way: 5 minutes
Bus: 21 or 21a

Bed size

- Upgraded room with/without washbasin:
single bed, 3'0"x6'3" (91cm x 190.5cm)
- Upgraded room with/without washbasin:
small double bed, 4'0"x6'3" (122cm x 190.5cm)

Each room contains bed, desk, chair, shelves, wardrobe
and rubbish bin. There is also space for storage under
the bed (not purpose-built).

Bedding packs and mattress toppers are available
to purchase online or from your local reception.

Up to five residents **share a bathroom**. There are
separate showers and WCs. Shared bathrooms are
cleaned for you and toilet paper is provided.

Example standard shared bathroom floorplan

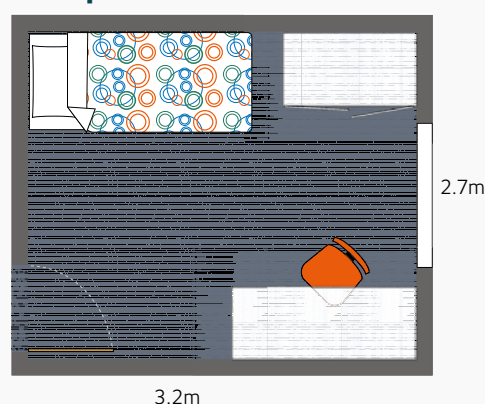

Example standard washbasin shared bathroom floorplan

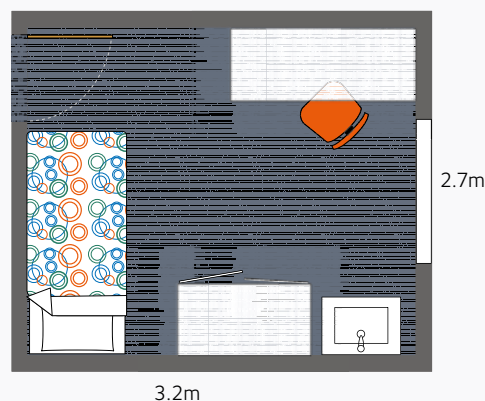

Not to scale. Room measurements are approximate only. This is not
the guaranteed size of your room. Approximate room size = 8.6m²
(depending on specific room type).

Need to get in touch?

accommodationonline@reading.ac.uk
0118 200 5011
+44 118 200 5011 (international)

View more images on our flickr **here**