

GREENOW HOUSE



Things you need to do before you arrive

1. Read your student residence agreement [here](#).
2. Complete your compulsory induction via the accommodation portal.
3. Book your arrival slot.
4. Read the *Halls A-Z handbook*.
5. Visit **Welcome to the University of Reading**.

Need to get in touch?

accommodationonline@reading.ac.uk
0118 200 5011
+44 118 200 5011 (international)

.....
View more images on our flickr [here](#)

KEY FACTS

GREENOW HOUSE

Hall address

Your name, flat, house
Windsor Hall
Shinfield Road
Reading, RG6 6HW

Greenow House is part of Windsor Hall within Park Group.

Reception

Reception is on the ground floor of Windsor Hall.

Post

Postboxes are on the outside wall of Park Lounge.
Collect parcels and registered mail from Park Reception
between 08:30–09:30 and 14:00–18:30.

Lift access

No, rooms arranged over four floors.

Social facilities

Park Lounge room contains a TV screen and pool table.
Located opposite Park Eat. Allocated study space
is Park Lounge.

Special requirements

No Quiet Lifestyle or single-sex areas available in this hall.

Meal Plan?

The University recommends all first year students enrol onto a Meal Plan. If you haven't already, you can enrol onto a fixed price Meal Plan, ranging from 3 to 21 meals per week, by visiting www.reading.ac.uk/clevercuisine. The closest catering outlet is Park Eat.

Your kitchen

Each Kitchen is equipped with a fridge/freezer, kettles, toasters, microwave, hobs and oven and is shared between six and nine residents. Each resident has one fridge and freezer shelf and two cupboards.

Do I need induction pans?

No. Greenow House has standard electric ovens and hobs. You do not need a particular type of pan. If purchasing a kitchen pack, please select 'standard hob kitchen pack'.

Walking distance

9 minutes to central Whiteknights Campus.

Nearest public transport

UoR Chancellor's Way: 5 minutes
Bus: 21 or 21a

Bed size

- En-suite: single bed, 3'0"x6'3" (91.5cm x 190.5cm)

Each room contains bed, desk, curtains, chair, shelves, wardrobe and rubbish bin.

Bedding packs and mattress toppers are available to purchase online or from your local reception.

En-suite bathrooms have a toilet, sink, washbasin and shower with curtain in a 'wet room' style and a fixed showerhead.

Example en-suite floorplan

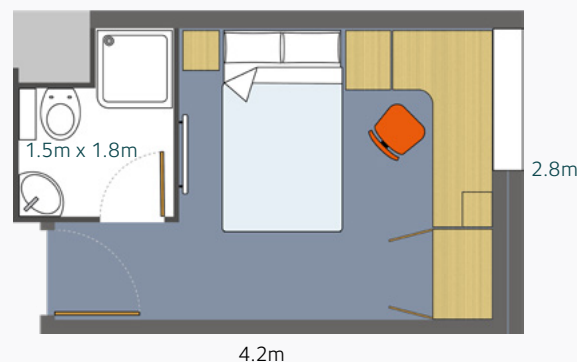

Not to scale. Room measurements are approximate only. This is not the guaranteed size of your room. Approximate room size = 11.2m².

Need to get in touch?

accommodationonline@reading.ac.uk

0118 200 5011

+44 118 200 5011 (international)

View more images on our flickr [here](#)