



Things you need to do before you arrive

1. Read your student residence agreement [here](#).
2. Complete your compulsory induction via the accommodation portal.
3. Book your arrival slot.
4. Read the *Halls A-Z handbook*.
5. Visit **Welcome to the University of Reading**.

Need to get in touch?

accommodationonline@reading.ac.uk

0118 200 5011

+44 118 200 5011 (international)

View more images on our flickr [here](#)

KEY FACTS

CHILDS HALL

Hall address

Your name, flat, block
Childs Hall, Shinfield Road, Reading
RG6 6JP (Padworth) RG6 6JS (Sonning)
RG6 6JQ (Quainton) RG6 6JT (Tidmarsh)
RG6 6JR (Ruscombe)

Childs Hall is part of Park Group.

Reception

Reception can be found on the ground floor of Windsor Hall.

Post

Postboxes are on the outside wall of Park Lounge.
Collect parcels and registered mail from Park Reception
between 08:30–09:30 and 14:00–18:30.

Lift access

Yes, up to five floors in each block.

Social facilities

Park Lounge room contains a TV screen and pool table.
Located opposite Park Eat. Allocated study space is
Padworth Study Space.

Special requirements

Designated Quiet Lifestyle Hall. Single-sex areas and
some accessible rooms are available.

Meal Plan?

The University recommends all first year students enrol onto a Meal Plan. If you haven't already, you can enrol onto a fixed price Meal Plan, ranging from 3 to 21 meals per week, by visiting www.reading.ac.uk/clevercuisine. The closest catering outlet is Park Eat.

Your kitchen

Each Kitchen is equipped with a fridge/freezer, kettles, toasters, microwave, hob and oven and is shared between six to ten residents. Each resident has two cupboards and one fridge and freezer shelf.

Do I need induction pans?

Yes. Childs Hall has induction hobs. You need a particular type of pan called 'Induction pans'. We suggest stainless steel flat bottom pans. If purchasing a kitchen pack, please select 'induction hob kitchen pack'.

Walking distance

9 minutes to central Whiteknights Campus.

Nearest public transport

UoR Chancellor's Way: 3 minutes
Bus: 21 or 21a

Bed size

- Premium en-suite:
small double, 4'0"x6'3" (122cm x 190.5cm)

Each room contains bed, desk, chair, shelves, wardrobe, curtains and rubbish bin. There is also storage under the bed.

Bedding packs and mattress toppers are available to purchase online or from your local reception.

En-suite bathrooms have a toilet, sink, washbasin and shower with a curtain and an adjustable showerhead. Accessible rooms have a 'wet room' style bathroom. They also have a shaver/toothbrush socket.

Example premium en-suite floorplan

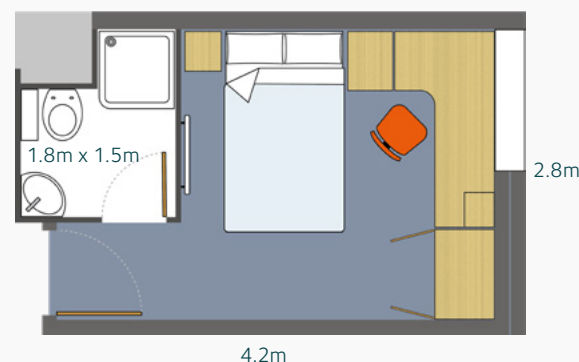

Not to scale. Room measurements are approximate only. This is not the guaranteed size of your room. Approximate room size = 11.8m².

Please note Childs Hall is undergoing planned building enhancement works during academic year 2025/26. This may extend into the academic year 2026/27. Should this be the case and your room booking is affected, compensation will be applied to rooms impacted at a rate of 5% or 10% where relevant. For further information please visit this webpage: **Planned building enhancements 2025/26**.

Need to get in touch?

accommodationonline@reading.ac.uk

0118 200 5011

+44 118 200 5011 (international)

View more images on our flickr [here](#)