

# International Foundation Pathways



# Contents

---

Welcome	3
Reasons to study an International Foundation Pathway at Reading	4
Henley Business School	6
Reading at a glance	8
Reading town and location	10
University of Reading Rankings	12
International Foundation Pathways	14
1-year International Foundation Programme (IFP)	14
4-year integrated programme with International Foundation Year (IFY)	16
Academic English and Skills	18
English Entry Requirements	19
Student support	20
Boost your employability	21
Popular progression degrees	22
Scholarships	25
Living in halls	26
Make Reading your home	27
Students' Union and SportsPark	28
How to apply	30
Entry requirements and progression degrees	31



# Welcome

---



**One of the first universities to establish a course of its type in the UK, the University of Reading's International Foundation Pathways provide students from around the world with the support, skills and ideal learning environment in which to begin their higher education journey.**

Reading has a long tradition of welcoming international students, starting with its first student from Kenya in 1904. Today, the University hosts around 23,000 students from over 160 countries, creating a vibrant and multicultural environment.

By choosing the University of Reading International Foundation Pathways, you are selecting a foundation programme delivered entirely by university academics, ensuring that you will receive high-quality support, structured academic development and a clear pathway to success in your chosen undergraduate degree and beyond.

Overall, University of Reading Global Academy will provide you with a rewarding and enjoyable student experience, equipping you with the skills and confidence needed to start your undergraduate studies. I look forward to seeing you join our International Foundation Pathways and welcoming you to our UK campus.

## **Natalie Drake**

Associate Professor  
Director, International  
Foundation Pathways

**[rdg.ac/international-foundation](https://rdg.ac/international-foundation)**

# Reasons to study an International Foundation Pathway at Reading

At the University of Reading Global Academy, we don't just help you start your degree – we help you succeed in it, and beyond. With over 100 years of experience supporting international students like you, we're with you every step of your journey – from foundation and throughout further levels of study. You'll build the skills, confidence, and knowledge to achieve your goals and feel part of a global academic community.

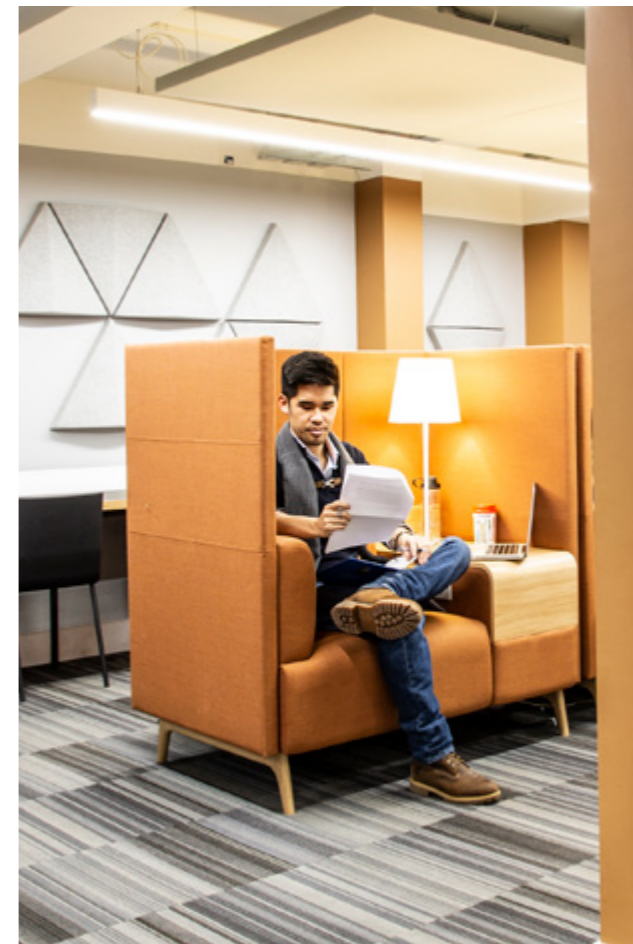



 University of Reading student from day one

 A choice of September or January start<sup>1</sup> and a wide range of subjects

 Guaranteed opportunity to progress<sup>2</sup>

 University owned IFP with 40 years of experience

 Taught by experienced University of Reading academics

 One-to-one tutor support

**98%** In 2024, 98% passed the IFP and 92% were able to progress to a University of Reading degree

 Access to all academic, social, and sports facilities

 Guaranteed accommodation on an award-winning campus. (See page 26 for more details)

 You will meet international friends outside of your degree subject

 Careers Support

 Access to volunteering, extracurricular activities and campus jobs

 Access to IFP Excellence and University Scholarships

 Practical teaching in small groups

 Wide variety of events

<sup>1</sup> Some degrees only start in September.  
<sup>2</sup> Other relevant degree entry requirements also need to be met.

# Study at an elite business school, with a worldwide reputation for excellence<sup>3</sup>

**Part of the University of Reading, Henley Business School is a truly international institution with over 7,000 students from more than 100 countries.**

With more than 100,000 alumni in over 160 countries, we are one of the oldest and most respected schools in Europe.

Henley Business School is one of only 145 business schools globally to hold the triple crown accreditation from AACSB, EQUIS and AMBA.<sup>4</sup>

Our academics and distinguished industry experts will help you gain valuable skills relevant for many fast-paced industries.

No matter what degree you choose to study at Henley, you can be sure that you are laying a strong foundation for your future career.

As an International Foundation Programme student, you can progress to undergraduate degrees in Henley Business School or you can study **BSc Mathematics with Finance and Investment Banking with International Foundation Year** as a 4-year degree.<sup>5</sup>

## Dedicated industry facilities

Put your understanding of financial systems and capital markets into practice in the International Capital Market Association (ICMA) Centre's dealing rooms, the largest non-investment bank facilities of their kind in Europe.

- Learn the secrets of trading
- Build your own asset portfolio
- Develop your financial analysis skills by processing complex data
- Gain exposure to a real-life market setting

## Benefit from our range of professionally-accredited courses

Many of our courses provide exemptions and/or credit for prior learning from professional bodies including the Institute of Chartered Accountants in England and Wales (ICAEW), the Association of Chartered Certified Accountants (ACCA), the Chartered Institute of Management Accountants (CIMA) and the Chartered Institute of Marketing (CIM).

## Preparing you for a successful career

We are in the heart of the UK's 'Silicon Valley' and have strong working relationships with companies in and around Reading, including Microsoft, IBM and the Big Four accounting firms. At Henley, our aim is to increase your knowledge, skills and confidence, and prepare you for a professional career.

- All of our undergraduate programmes have employability integrated within them.
- Seize work experience opportunities and access our extensive business relationships.
- Gain valuable skills relevant for many fast-paced industries.

Receive specialist support from **our dedicated careers team.**



**When you study at Henley, you'll have access to a wide range of facilities, both within Henley Business School and across the University. Henley's dedicated facilities include:**

### Henley Business School Library

The Henley Business School Library is for the exclusive use of Henley students and faculty. It offers space for study, a loan collection of books, and online specialist resources.

Knowledgeable staff are always available to provide assistance and advice.

### Entrepreneurship Hub

If you're a budding entrepreneur, you can apply to access Henley's designated Entrepreneurship Hub where you can work on your business ideas alongside like-minded students.

The hub includes shared IT facilities and office space, providing opportunities for students to share ideas, offer each other assistance and even build partnerships.

### Henley Business School Building and Café

The foyer of the Henley Business School Building is home to the Henley Business School Café, where you can grab a bite to eat in between lectures. The foyer also has plenty of seating where you can study or socialise with fellow students.

Find out more [henley.ac.uk/study/undergraduate](https://henley.ac.uk/study/undergraduate)



<sup>3</sup> 145 business schools in the world have triple-accredited status from the leading UK, European and US accrediting bodies: Association of MBAs (AMBA); European Foundation for Management Development (EQUIS); Association to Advance Collegiate Schools of Business (AACSB)

<sup>4</sup> AACSB: Association to Advance Collegiate Schools of Business; AMBA: Association of MBAs; and EQUIS: European Quality Improvement System. 16 November 2025

<sup>5</sup> Upon successful completion and meeting any further required entry requirements, you will be guaranteed the opportunity of a place on your undergraduate course at Reading, or will progress to year one of your 4-year degree, whichever is relevant.

# Reading at a glance



**Top 200**  
in the world and  
**top 30**  
in the UK<sup>6</sup>



Around  
**23,000**  
students from  
around **160**  
countries<sup>7</sup>



**200**  
societies and  
clubs, all of which  
are run voluntarily  
by students



**23mins**  
central London  
(by train) and  
**45mins**  
to Heathrow Airport  
(by car/coach)



**98%**  
of our research is  
rated as being of  
international  
standing<sup>8</sup>



**150 years**  
of history with origins  
as a University of  
Oxford extension  
college



**130**  
hectares of  
beautiful parkland.  
It is an exceptional  
environment in  
which to study,  
live and relax



**A short  
walk or  
bus ride**  
from the centre  
of Reading with its  
lively mix of culture,  
nightlife, shops and  
eating-places



Contemporary  
study facilities,  
halls of  
residence,  
support services,  
cafés and bars

“The thing I liked most about the IFP was the strong foundation I was able to build, allowing me to progress swiftly into my first year as an undergraduate.”

Deema – 2020/21 – BSc Nutrition

<sup>6</sup> We're the 27th highest ranked UK university out of 90 featured in the QS World University Rankings 2026. We're ranked 194th overall out of 1,501 institutions worldwide.  
<sup>7</sup> HESA Student Record, 2019/2020.  
<sup>8</sup> The latest Research Excellence Framework (REF) 2021, combining the University's 4\* (world leading), 3\* (internationally excellent) and 2\* (internationally recognised) submissions.

# Reading town and location

**Reading is a global town: a centre of innovation, cultural diversity, creativity, and technology.**



Global cuisine



Ethnic grocery stores



Parks, countryside, and riverside walks



Large shopping centre



Leisure and entertainment facilities



Historical Reading Abbey Ruins and Museum



## Easy to reach

Regular fast trains to London Paddington

24-hour bus service from Reading train station to University of Reading campus

Reach Heathrow Airport by rail or road in under an hour and Gatwick Airport in under two hours.

## Fastest train travel times

Reading to London Paddington: 23 minutes

Reading to Oxford: 22 minutes

Reading to Bristol Parkway: 48 minutes

According to Great Western Railway

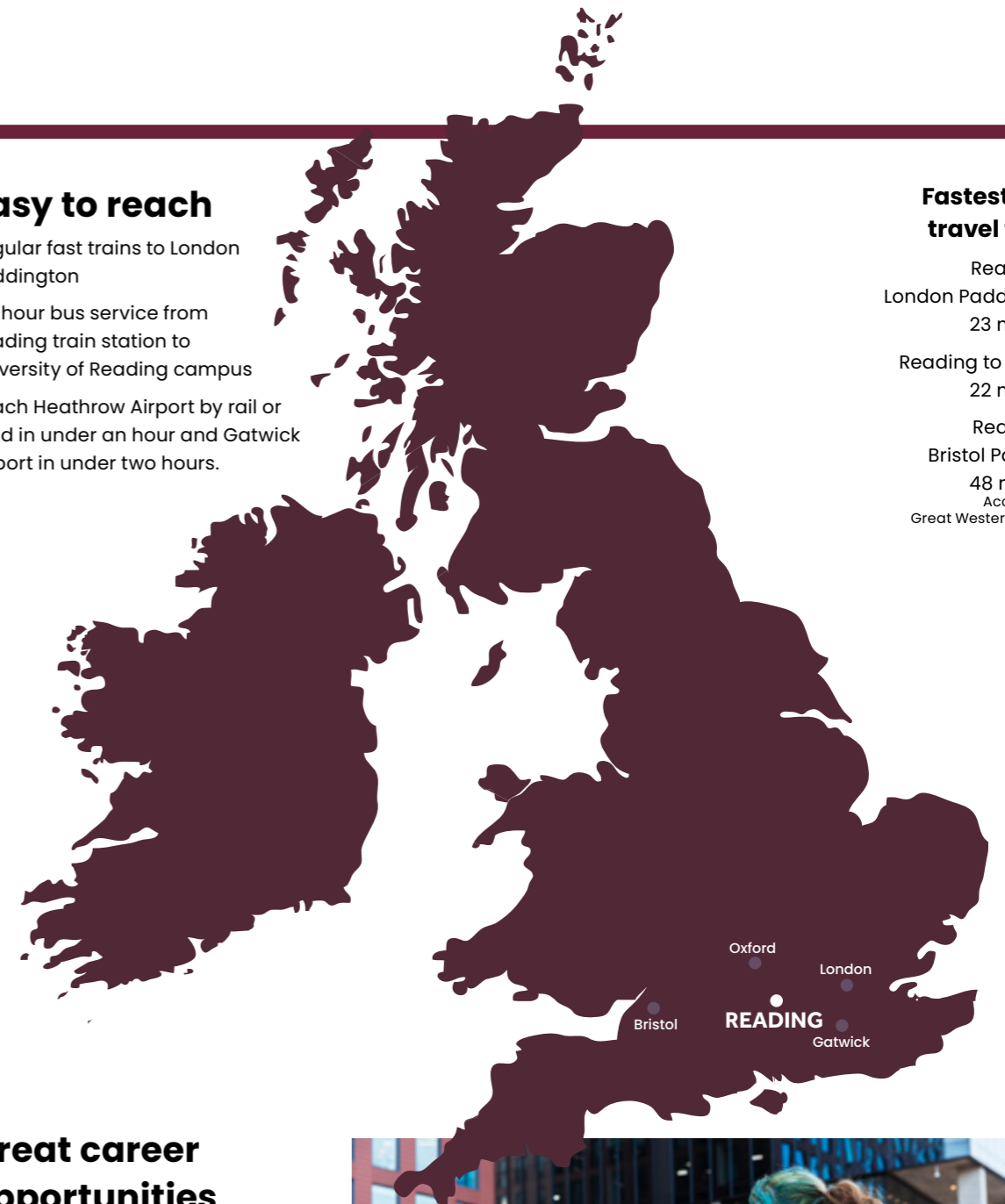

## Great career opportunities

Located in a region with a buoyant economy

Reading is home to the headquarters of international businesses: Microsoft, Oracle, Procter & Gamble, and PwC have long been located here.

The University's Thames Valley Science Park is home to a major new film and TV complex, Shinfield Studios, and the British Museum Archaeological Research Collection.



# University of Reading Rankings

## QS world rankings



**Highest placed** UK University for **Agriculture and Forestry** at 20th in the world<sup>9</sup>



**Top 150** in the world for **Architecture and Built Environment**<sup>10</sup>



**Joint 25th** highest ranked UK **Law School**<sup>11</sup>



**Top 100** in the world for **Arts and Humanities**<sup>12</sup>



**Top 50** in the world for **Archaeology**<sup>13</sup>

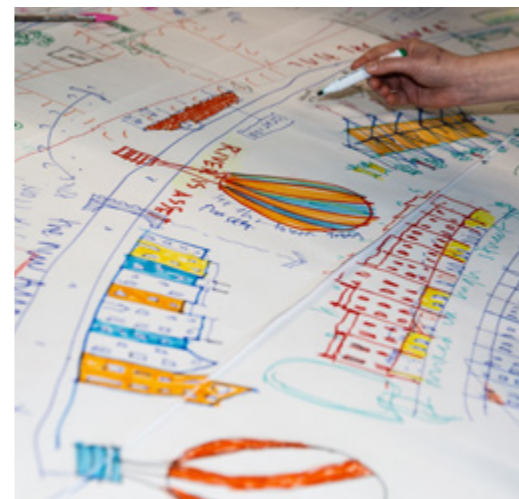

## UK rankings



**1st** in the UK for overall subject in **Land and Property Management**<sup>14</sup>



**6th** in the UK for research power in **Architecture, Built Environment, and Planning**<sup>16</sup>



**3rd** in the UK for **Nutrition and Food Science**<sup>18</sup>



**7th** in the UK for **Graphic Design**<sup>20</sup>



**1st** in the UK for **Architecture, Building and Planning**<sup>22</sup>



**10th** in the UK in **Business and Economics** subjects<sup>15</sup>



**1st** in the UK for **Business Studies**<sup>17</sup>



**10th** in the UK for **Pharmacy and Pharmacology**<sup>19</sup>



**5th** in the UK for **Politics**<sup>21</sup>



**30th** in the UK for overall subject in **Accounting and Finance**<sup>23</sup>

## Shanghai rankings



**5th** in the world for **Atmospheric Science**<sup>24</sup>

## Also...

One of only 145 business schools globally to hold **triple-accredited status**

- Association of MBAs (AMBA)
- European Foundation for Management Development (EQUIS)
- Association to Advance Collegiate Schools of Business (AACSB)

<sup>9</sup> QS World Rankings by Subject, Agriculture and Forestry, 2025

<sup>10</sup> QS World University Subject Rankings 2025

<sup>11</sup> QS World University Subject Rankings 2025

<sup>12</sup> QS World University Subject Rankings 2025

<sup>13</sup> QS World University Subject Rankings 2025

<sup>14</sup> Complete University Guide 2026

<sup>15</sup> Times Higher Education World University Rankings by Subject 2025, United Kingdom providers only

<sup>16</sup> Times Higher Education, Institutions Ranked by Subject, based on its analysis of the latest REF 2021

<sup>17</sup> Daily Mail University Guide, 2026.

<sup>18</sup> Guardian University Guide 2026

<sup>19</sup> Ranked 10th in the Daily Mail University Guide 2025

<sup>20</sup> Guardian University Guide 2025

<sup>21</sup> Daily Mail University Guide 2025

<sup>22</sup> Daily Mail University Guide 2026

<sup>23</sup> Guardian University Guide 2025

<sup>24</sup> Reading is 1st out of the UK universities ranked in the Shanghai Ranking 2024 Global Ranking of Academic Subjects

# International Foundation Pathways

At the University of Reading, you have the choice to study the 1-year International Foundation Programme (IFP) or a wide range of 4-year degrees with integrated International Foundation Year (IFY) (see p16).

The International Foundation prepares you for undergraduate study in three ways:

- you will receive academic training in subjects for your undergraduate degree
- you will develop your English language abilities
- you will acquire the transferable academic skills needed for undergraduate studies and beyond.

During your first year of both programmes you will study modules that will give you the knowledge, academic training, language, skills and confidence you need for your undergraduate degree.

The standard IFP programme has two entry points – September and January – both options provide the same quality and benefits. Students wishing to progress onto a science degree will need to take the IFP September start.

## 1-year International Foundation Programme (IFP)

The IFP is a one-year standalone foundation programme for international students. The IFP is split into different pathways. The pathway you study under is determined by the degree programme you intend to progress to after your foundation year. Within each pathway, students will take a set of modules that closely align with their intended degree. The modules you take will help prepare you for the modules you will take as an undergraduate student at the University of Reading.

You will be enrolled in one of three pathways:

### Science and Mathematics Pathway

#### Compulsory modules

Academic English and Skills

Core Modules

### Business, Management and Finance Pathway

#### Compulsory modules

Academic English and Skills

Core Modules

### Social Sciences and Art Pathway

#### Compulsory modules

Academic English and Skills

Core Modules



“The IFP allows me to meet the requirements for my undergraduate course and gives me an opportunity to connect with peers from different cultures. In my time here, adjusting to my new environment has been a smooth process. The university feels like home.”

Justin – 2024/25 – BSc Computer Science



## 4-year integrated programme with International Foundation Year (IFY)

There are a number of International Foundation Year programmes (IFYs) across different Schools in the University of Reading.

If you have already decided on the subject you wish to study, an alternative to the IFP is a 4-year undergraduate degree with an integrated International Foundation Year (year 0).

The first year of study (year 0) you will take an Academic English and Skills Module and two core modules in your pathway.

After successful completion you can progress onto your chosen undergraduate degree at Reading.

These 4-year programmes enable you to apply for a single visa to cover the full 4 years of study.

September or January entry are available, except where indicated.

### Courses

BSc Agriculture with International Foundation Year\*

BSc Agricultural Business Management with International Foundation Year

BEng Architectural Engineering with International Foundation Year\*

BSc Building Surveying with International Foundation Year

BSc Construction Management with International Foundation Year

BSc Construction Management and Surveying with International Foundation Year

BSc Consumer Behaviour and Marketing with International Foundation Year

BA Economics with International Foundation Year

BSc Economics and Finance with International Foundation Year

BSc Environmental Science with International Foundation Year\*

BSc Food Business and Marketing with International Foundation Year

BSc Food Science with International Foundation Year\*

LLB Law with International Foundation Year\*

BSc Mathematics with International Foundation Year\*

BSc Mathematics with Finance and Investment Banking with International Foundation Year\*

BSc Meteorology and Climate with International Foundation Year\*

BA Museum Studies and Archaeology with International Foundation Year

BA Politics and International Relations with International Foundation Year

BSc Psychology with International Foundation Year\*

BSc Quantity Surveying with International Foundation Year

\* September entry only.

**It's a great transition coming from another educational background. It was a wonderful opportunity for me and a really great experience. I met some phenomenal people from all around the world.**

Caitlin, BA Museum Studies and Archaeology with International Foundation Year

# Academic English and Skills

All students will take a module aimed to help you develop the study skills necessary to study at a UK university. By the end of the module, it is expected that you will be able to:

- produce written work which is well-organised, relevant and makes use of appropriate terminology and academic style
- demonstrate good communication skills in written and/or oral form
- identify problems, apply your knowledge and skills in finding solutions and evaluate these solutions
- think critically, in order to recognise and express well-reasoned arguments in academic writing
- interpret and analyse a range of information beyond mere description
- work as a member of a team by cooperating with others, negotiating, listening to others in the group, sharing responsibilities/tasks and meeting deadlines.



# English Entry Requirements

## International Foundation Programme (1 year)

The IELTS requirements for the IFP and IFY September start

Intended Degree Pathway	IFP IELTS	IFY IELTS
Science and Mathematics Pathway (except Speech and Language Therapy and Pharmacy*)	5.0 (no skill below 4.5)	5.5 (no skill below 5.5)
Business, Management and Finance Pathway	5.5 (no skill below 4.5)	5.5 (no skill below 5.5)
Social Sciences and Art Pathway: Social Sciences	5.5 (no skill below 4.5)	5.5 (no skill below 5.5)
Social Sciences and Art Pathway: Arts, Humanities	6.0 (no skill below 5.0)	6.0 (no skill below 5.5)
*Speech and Language Therapy	6.5 (no skill below 5.5)	n/a
*Pharmacy	5.5 (no skill below 5.0)	n/a

The IELTS requirements for the IFP and IFY January start

The requirements are the same as listed above for the Business, Management and Finance Pathway, and the Social Sciences and Art Pathway.

The Science and Mathematics Pathway can only be studied on the IFP and IFY September start programme.

Read more about academic entry requirements: [reading.ac.uk/global-academy/international-foundation-pathways/ifp-entry-requirements](https://reading.ac.uk/global-academy/international-foundation-pathways/ifp-entry-requirements)



See further information at [rdg.ac.uk/international-foundation](https://rdg.ac.uk/international-foundation)



# Student support

Students are supported in the academic journey from day one of their International Foundation Studies.

Whether you need help with a specific topic you are learning in one of your modules, or are having trouble organising your study time, or need someone to talk to, you will find support on campus. Students also have access to all University of Reading support services from day one.

Find out more: [reading.ac.uk/essentials](https://reading.ac.uk/essentials)

## University Library:

- Open 24/7 during the Semester.
- Group study areas.
- Individual and quiet study spaces.
- A dedicated Academic Liaison Librarian.

## Academic Tutor

All students will be allocated an Academic Tutor while studying the International Foundation. The Academic Tutor will support you in the following ways:

- tracking your engagement with modules
- being available for one-to-one meetings when needed
- holding mandatory meetings each semester to keep you updated on important information
- signposting to services around campus: wellbeing, careers, study advice, life tools, visa, finance, and more.



# Boost your employability

Our award-winning<sup>25</sup> Careers and Placements Team is here to help you prepare for your future, wherever your ambitions lie. You'll receive career support throughout your studies, and for an additional 24 months after graduating<sup>26</sup>. This sustained focus on employability contributes to the success of our graduates: 93% of our undergraduates are in work or further study within 15 months of the end of their course<sup>27</sup>.

Discover more about careers and employability support at Reading: [reading.ac.uk/essentials/careers](https://reading.ac.uk/essentials/careers)



## We provide you with:

- career coaching sessions
- CV workshops
- job and graduate scheme application support
- interview skills training
- career and networking events with local, national and international companies
- online digital employability tools and advice
- alternative options support such as postgraduate study, taking time out, or setting up your own business.

You can also take advantage of our internship scheme RIS [reading.ac.uk/essentials/careers/gaining-experience/ris](https://reading.ac.uk/essentials/careers/gaining-experience/ris)

You can develop your employability skills through our RED Global Engagement Award [reading.ac.uk/essentials/Careers/Gaining-experience/RED-Awards/RED-Global-Engagement-Award](https://reading.ac.uk/essentials/Careers/Gaining-experience/RED-Awards/RED-Global-Engagement-Award)

You can find out about student job opportunities through our Careers Team website [reading.ac.uk/essentials/Careers](https://reading.ac.uk/essentials/Careers)

<sup>25</sup> Strategic Innovation Award, AGCAS Award for Excellence 2023 and Best University for Work Experience 2023–2024, Rate my Placement.  
<sup>26</sup> Henley Business School students can access four years of alumni support.  
<sup>27</sup> Based on HESA data, Graduate Outcomes Survey 2021/22, of 2,979 first degree leavers, of which 48% responded.

# Popular progression degrees

## Law

**17th highest-ranked UK Law School for Employer Reputation<sup>28</sup>.**

Study law at Reading and develop your legal knowledge and skills in a highly practical way, with plenty of opportunities to build real-life legal experience. You will have the opportunity to take part in client interviewing, negotiation, and mooting competitions, with work experience placements offered as prizes. University of Reading's School of Law also hosts one of the largest pro bono programmes in the UK.

## Meteorology and Climate

**Ranked 5th in the world for Atmospheric Science<sup>29</sup>.**

On our BSc Meteorology and Climate course you will tackle the biggest issues facing the planet today, including ozone depletion and climate change, alongside world experts in the UK's only dedicated meteorology department. This course is approved by the Royal Meteorological Society as appropriate academic training for meteorologists seeking the qualifications of Chartered Meteorologist (CMet) or Registered Meteorologist (RMet).

## Business and Management

**1st in the UK for Business Studies (Daily Mail University Guide 2026).**

Our degrees give you a strong grounding across the main areas of business and are designed to prepare you for professional leadership and managerial roles in the private and public sector as well as in entrepreneurial enterprises. We welcome guest speakers from a wide range of organisations, from entrepreneurial start-ups to leading multinational firms.

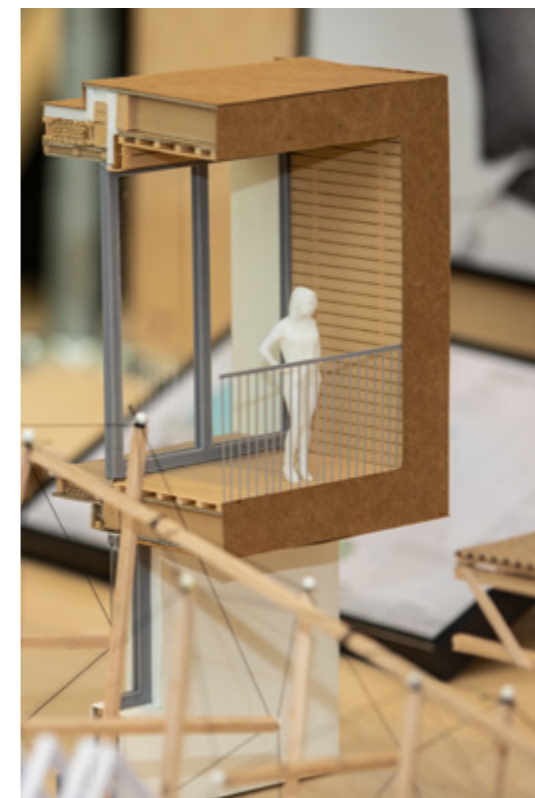
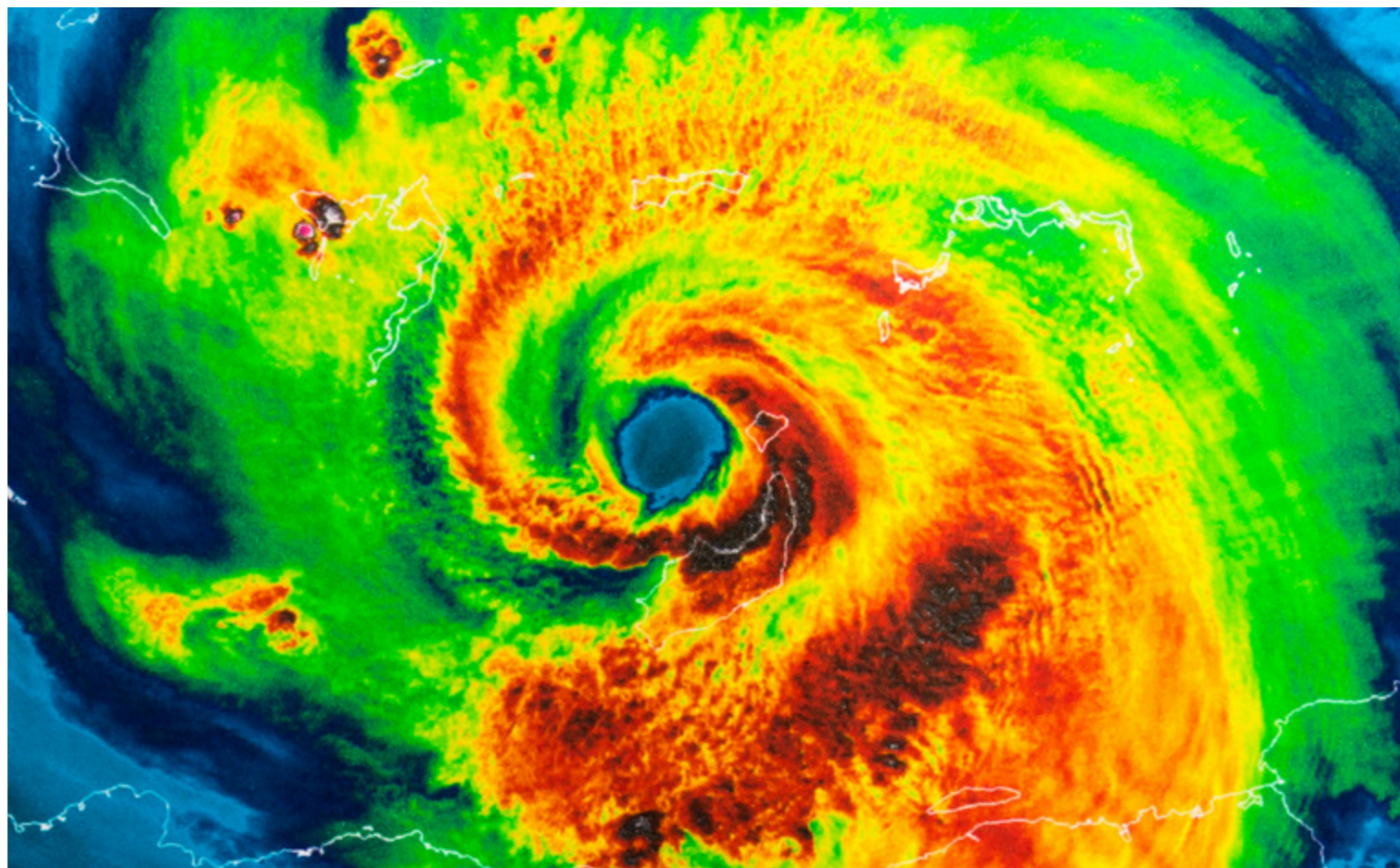

## Real Estate

**1st in the UK for overall subject in 'Land and Property Management' (Complete University Guide 2026).**

Students on our Real Estate & Planning degrees benefit from strong connections with the leading property and planning groups including the Royal Institution of Chartered Surveyors (RICS), who have accredited all of the programmes. Longstanding relationships with major employers mean that the majority of students secure jobs with the most highly regarded firms in the industry before they finish their course.

## Mathematics

**We offer courses that are accredited by the Institute of Mathematics and its Applications. This enables you to apply for Chartered Mathematician status upon graduation.**

Our research has contributed to knowledge in areas such as weather prediction, climate forecasting, and the design and analysis of clinical trials. All the courses we offer are available with the option of a paid placement in industry that forms a recognised part of the degree.

## Computer Science

**Study in a major UK digital tech and AI hub.**

Our excellent facilities and software support your core studies, but also ensure that you are able to pursue your own projects and interests. Major international companies such as IBM, Microsoft, Sony and Nationwide are actively involved in our courses. Companies such as Microsoft, Oracle, Cisco Systems, and Intel have their UK headquarters nearby.

## Architecture

**BSc (Hons) Architecture is prescribed by the Architects Registration Board (ARB). It is also validated by the Royal Institute of British Architects (RIBA).**

You'll benefit from strong industry links, work on live projects, and will have the opportunity to attend field trips across the UK and abroad. Our newly refurbished design studios mirror professional architectural offices. Our green campus provides a peaceful setting and a living test ground for models.

<sup>28</sup> QS World University Subject Rankings 2025

<sup>29</sup> Shanghai Ranking 2024 Global Ranking of Academic Subjects

## Bioveterinary Sciences

**Ranked 20th in the world and 1st in UK for Agriculture and Forestry<sup>30</sup>.**

Studying bioveterinary sciences at the University of Reading will equip you to succeed in a wide range of careers – from working in veterinary labs to becoming a researcher or animal nutritionist. You'll benefit from our campus-based labs and our farm. You'll have the opportunity to visit a range of animal-based organisations, such as veterinary practices, zoos, equine centres and farms, to gain real-world experience.



## Psychology

**Our psychology courses are accredited by the British Psychological Society (BPS).**

In psychology you'll explore the inner workings of the human brain. You'll also leave with a wide range of transferable skills including data handling, scientific analysis, problem solving and communication. The School houses state-of-the-art facilities to support research and learning including eye-tracking and specialist equipment for electrophysiology and transcranial magnetic stimulation (TMS). Additionally, we have various onsite clinics.



## Agriculture

**Ranked 20th in the world and 1st in UK for Agriculture and Forestry<sup>31</sup>.**

We have more than 130 years' experience of educating the world's agriculturalists. Our degrees are supported by an extensive programme of visits to regional farms, agricultural businesses, enterprises and organisations, including a residential course. You will also have access to our own 800 hectares of mixed farms and woodland, home to our modern research facilities and commercial farming enterprises.



## Film

**You'll be based at our purpose-built, £11m facilities that feature a multi-camera film and TV studio, a digital cinema, and dedicated recording studio and mixing suite.**

You'll also be close to Shinfield Studios (Netflix's 'Bridgerton' and Disney's 'Star Wars: The Acolyte' and 'Ghostbusters: Frozen Empire') which are built on our land and part of the Screen Berkshire partnership.

# Scholarships

## Excellence Scholarship

A select number of Excellence Scholarships will be awarded to International Foundation offer holders that show strong academic merit. For 2026/27 entry, the scholarship is **£5,000**.

To apply for funding, you must have received an IFP/IFY offer of admission for entry in the academic year 2026/27. After successful completion of your international foundation year and having achieved strong grades, you will be eligible to apply for the UG Excellence Scholarship, which is **£5,000 per year**.

See details at:  
[rdg.ac/international-foundation-scholarships](https://rdg.ac/international-foundation-scholarships)



## Global Sustainability Leaders Scholarship<sup>32</sup>

Start your undergraduate story with a Global Sustainability Leaders Scholarship.

The University of Reading will award scholarships across subject disciplines for up to 400<sup>33</sup> high achievers who will receive **£6,000 per academic year<sup>34</sup>** and opportunities to develop the knowledge, skills and networks to become sustainability leaders of the future.

Find out more at:  
[rdg.ac/gsl-scholarship](https://rdg.ac/gsl-scholarship)



# Living in halls

## University accommodation is safe, secure, and located close to our Whiteknights and London Road campuses.

Our rent prices are all-inclusive, meaning that your utility bills, Wi-Fi and basic contents insurance<sup>35</sup> are included.

### Benefits

**Variety.** We have nearly 5,000 rooms, including quieter lifestyle areas, and a number of adapted rooms for students with disabilities and special requirements<sup>36</sup>.

**Flexibility.** Standard contracts are 40 weeks or 51 weeks. Choosing a 51-week contract means you'll keep your room over the summer vacation.

### Security and support.

Dedicated security patrols, CCTV and a 24/7 Halls Hotline.

**Home at Halls.** Our residence life programme organises free and low-cost events for everyone living in halls.

We also offer single-sex options.

## Accommodation guarantee

You will be guaranteed a place in halls if you:

- are a new IFP/IFY student who holds Reading as a firm choice
- apply for accommodation by 1 August and satisfy any conditions of your academic offer by 2 September 2026.

Other restrictions and requirements may apply; check online for full details.

Explore room options and costs [reading.ac.uk/accommodation](https://reading.ac.uk/accommodation)



# Make Reading your home

Enjoy a beautiful, award-winning environment<sup>37</sup> perfectly suited to the diversity of our students.

### Feel at home

Our halls of residence are safe, secure, and within a 15-minute walk from the centre of Whiteknights campus. We offer a range of room types to suit different needs, preferences and budgets.

### Acres of space

Our campuses are full of green spaces to help you relax between lectures.

### Meet international students

The Global Study Lounge supports you with your transition, academic studies, and socialisation for the entirety of your time at Reading.

### Practise your English

Join our year round, award winning English Conversation Cafes. [reading.ac.uk/global-study-lounge/conversation-cafes](https://reading.ac.uk/global-study-lounge/conversation-cafes)

### Enjoy local and global food

Whiteknights campus regularly hosts an international street food market featuring cuisines from all around the world.

### Campus eateries

Enjoy healthy meals prepared with fresh ingredients sourced from our very own farms and other sustainable producers.

### Meal Plans

Our meal plan system gives you access to pre-paid meals each day. [reading.ac.uk/clevercuisine](https://reading.ac.uk/clevercuisine)

### Part time working

During your studies, you can work on or off campus. To find on-campus jobs: check Campus Jobs on Essentials. [reading.ac.uk/essentials/campus-jobs](https://reading.ac.uk/essentials/campus-jobs)

### Volunteering

You can gain extra experience by volunteering which will help with your C.V. [reading.ac.uk/essentials/Opportunities/Volunteering/Latest-opportunities](https://reading.ac.uk/essentials/Opportunities/Volunteering/Latest-opportunities)

<sup>35</sup> University accommodation insurance. Basic contents insurance is included in our rent prices. The basic level of contents insurance covers items in your room for fire, theft and flood for the duration of your halls contract. You should check the insurance policy carefully to make sure it meets your needs – for example, bicycles are included, but only up to a certain value. The policy has several restrictions, such as your laptop not being covered when outside your room, but it can be extended and personalised – for example, to cover your bike or laptop and/or items anywhere in the UK.

<sup>36</sup> Subject to availability.

<sup>37</sup> Whiteknights campus has been awarded 15 consecutive Green Flag Awards, 2011–2025.

# Students' Union and SportsPark

When you become a student at Reading, you automatically become a member of the Students' Union (SU). Reading Students' Union is a student-led organisation, completely independent of the University, based in the heart of Whiteknights campus. Everything it does is student inspired and student run, and all funds raised through its activities are invested right back into the SU for the benefit of our students.

The SU provides a huge range of opportunities to get involved, as well as spaces for you to relax, make friends and try something new. With over 150 sports teams, clubs and societies, you're sure to find a group where you can pursue your hobbies and passions. But if you don't, why not set up your own society and connect with students who love the same things you do?

[readingsu.co.uk](http://readingsu.co.uk)



You can also use our state-of-the-art fitness gym or take part in a range of activities at our SportsPark facilities on Whiteknights campus.

[sport.reading.ac.uk](http://sport.reading.ac.uk)



# How to apply

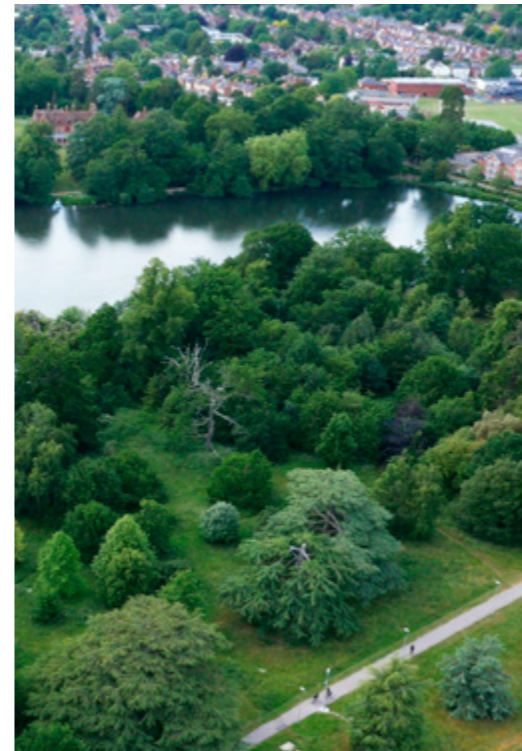
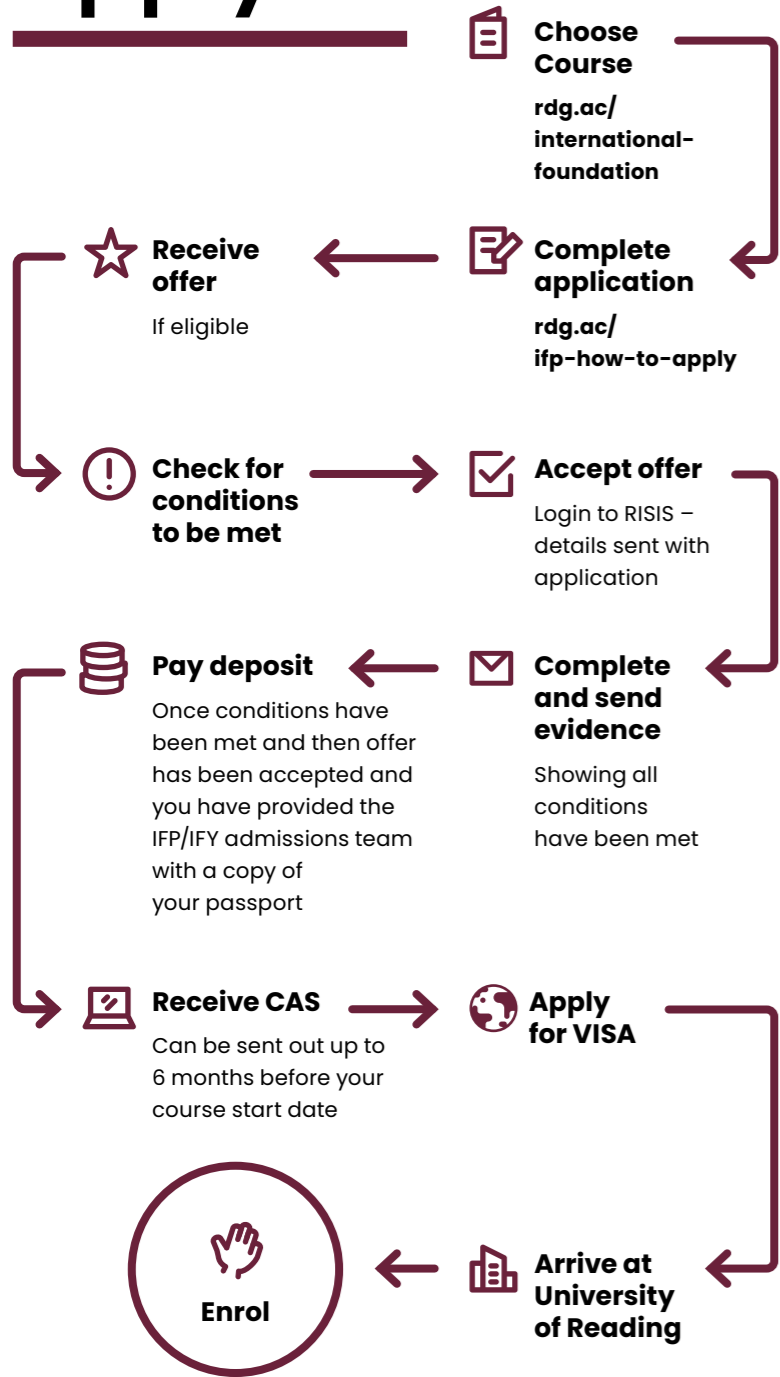

# Entry requirements and progression degrees

**IB Diploma:**

24 points overall.

**IB Certificate:**

at least 5 in all Standard Level subjects.

**IGCSE:**

5 passes at grades A\*-C in relevant subjects.

**AS and A Level:**

72 UCAS tariff points or above.

**We also accept country specific qualifications.**

**Find out more:** [reading.ac.uk/global-academy/international-foundation-pathways/ifp-entry-requirements](http://reading.ac.uk/global-academy/international-foundation-pathways/ifp-entry-requirements)



**International Foundation Programme Progression Degrees**

We offer more than 200 courses in the arts, sciences, social sciences, humanities, and business. Upon successful completion of the International Foundation Programme and any further entry requirements, you will be guaranteed the opportunity of a place on your undergraduate course at Reading.

- Accounting
- Agriculture
- Archaeology
- Architectural Engineering
- Architecture
- Art
- Biochemistry, Biology and Microbiology
- Biomedical Engineering
- Biomedical Science
- Bioveterinary Sciences
- Business & Management
- Chemistry
- Classics, Classical Studies and Ancient History
- Computer Science
- Criminology
- Economics
- Education Studies
- English Language and Linguistics
- Environment
- Film, Theatre & Television
- Finance
- Food Science
- Geography
- Graphic Communication
- Law
- Marketing
- Mathematics
- Meteorology and Climate
- Nutrition
- Pharmacology
- Pharmacy
- Philosophy
- Politics and International Relations
- Psychology
- Real Estate and Planning
- Sociology
- Speech and Language Therapy
- Surveying and Construction
- Zoology and Ecology

**Find your subject:** [reading.ac.uk](http://reading.ac.uk)

Speak directly to University staff for any questions you may have [forms.office.com/e/FhyXAmK2XZ](http://forms.office.com/e/FhyXAmK2XZ)





## International Foundation Pathways

[rdg.ac.uk/international-foundation](https://rdg.ac.uk/international-foundation)

**Ask us a question**

**[reading.ac.uk/question](https://reading.ac.uk/question)**



**Follow on Instagram:**

**University of Reading IFP**

[instagram.com/reading\\_ifp](https://www.instagram.com/reading_ifp)

**University of Reading International**

[instagram.com/uniofreading\\_int](https://www.instagram.com/uniofreading_int)

**University of Reading**

[instagram.com/uniofreading](https://www.instagram.com/uniofreading)



**Subscribe on YouTube:**

**Reading IFP**

[youtube.com/user/ifpreading/videos](https://www.youtube.com/user/ifpreading/videos)

**University of Reading**

[youtube.com/user/UniofReading/videos](https://www.youtube.com/user/UniofReading/videos)

### **Cream is the new green**

This paper is 100% recycled and made without the use of harmful chlorine. When you have finished with this brochure, please recycle it.

---

#### **Important information**

This brochure was issued in 2026 and is aimed at prospective undergraduate students wishing to apply for a place at the University of Reading (the University) and start a course in autumn 2026. The University makes every effort to ensure that the information provided in the brochure is accurate and up-to-date at the time of going to press (2026). However, it may be necessary for the University to make some changes to the information presented in the brochure following publication – for example, where it is necessary to reflect changes in

practice or theory in an academic subject as a result of emerging research; or if an accrediting body requires certain course content to be added or removed. To make an informed and up-to-date decision, we recommend that you check [reading.ac.uk/study](https://reading.ac.uk/study).

The University undertakes to take all reasonable steps to provide the services (including the courses) described in this brochure. It does not, however, guarantee the provision of such services. Should industrial action

or circumstances beyond the control of the University interfere with its ability to provide the services, the University undertakes to use all reasonable steps to minimise any disruption to the services.

#### **Copyright and trademarks**

© University of Reading, 2026.

The University of Reading name and logo are registered trademarks. All rights reserved.